

	4210 40	4210 41	4210 42	4210 43
A	1	1	1	1
C	1	1	1	1
C1	2	2	2	2
C2	2	2	2	2
C3	2	2	2	2
D	6	8	6	8
D1	6	8	0	0
E	0	0	6	8
E1	0	0	6	8
E2	12	16	6	8
E3	0	0	6	8
E4	2	2	2	2
E5	2	2	2	2
F1	1	2	1	1
F2	1	0	1	1
F3	0	0	0	1
F4	3	2	2	3
F5	0	0	2	2
F6	2	2	2	2
F9	1	1	1	1
F10	0	1	0	1
F11	2	4	2	4
F12	2	4	2	4
F13	2	4	2	4
E6	12	16	0	0
E7	12	16	0	0

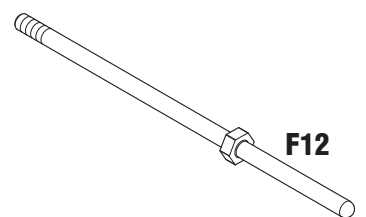

DPX³ 160 3P - 4P

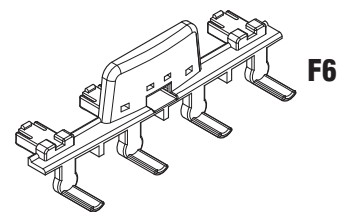
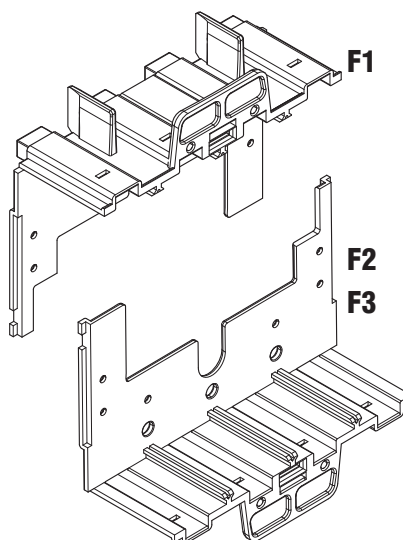
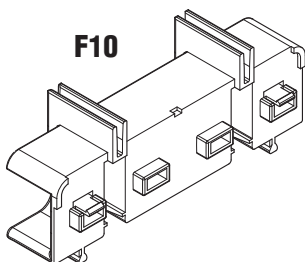
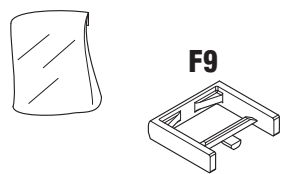
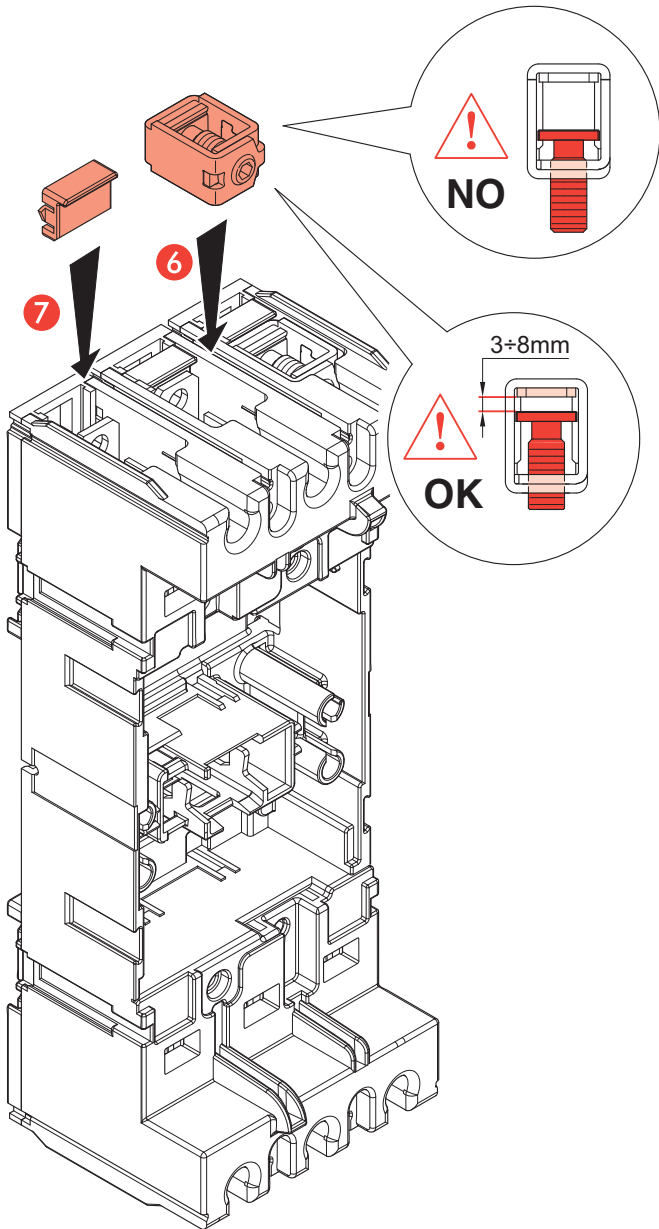
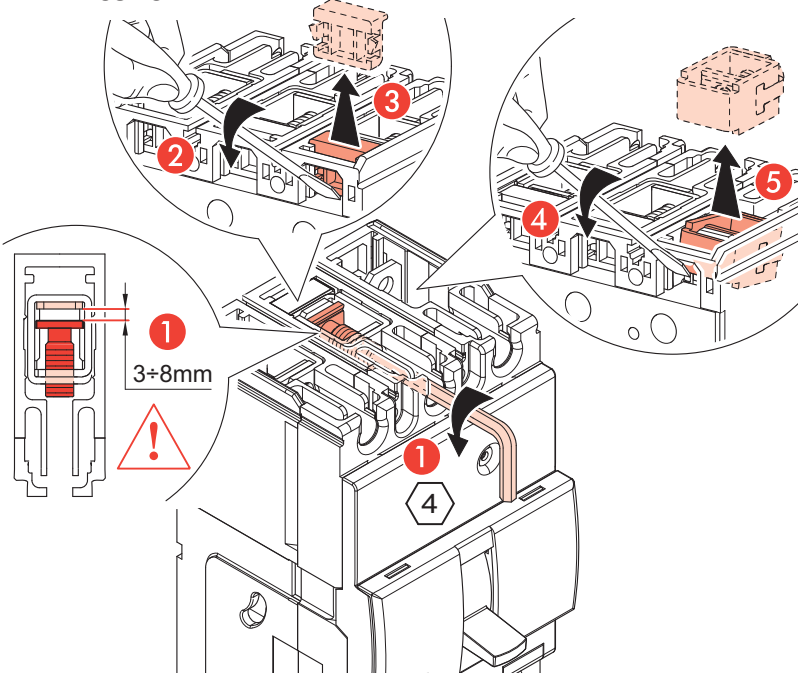

DPX³ 160 3P - 4P

1

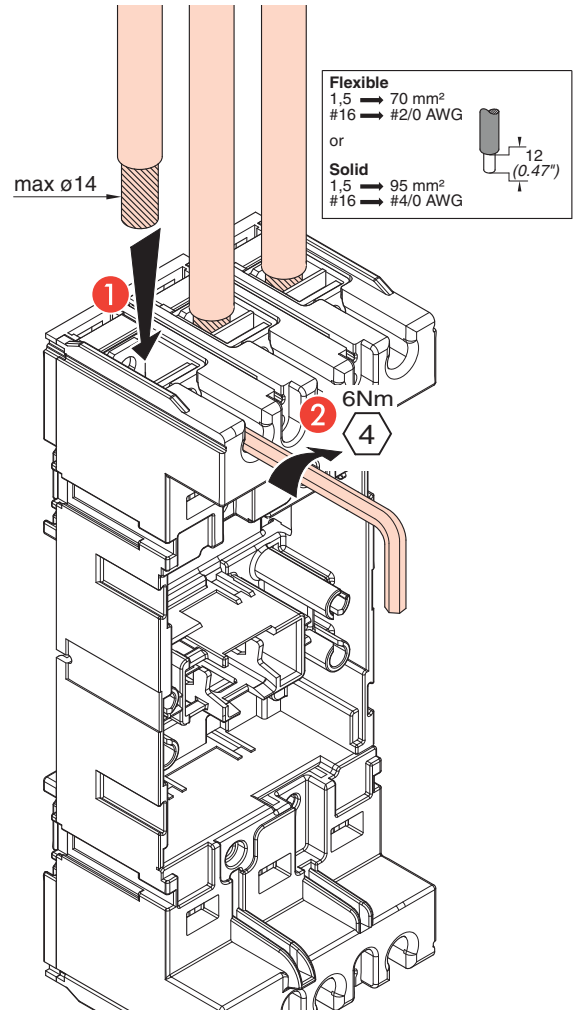

DPX³ 160 3P - 4P

2

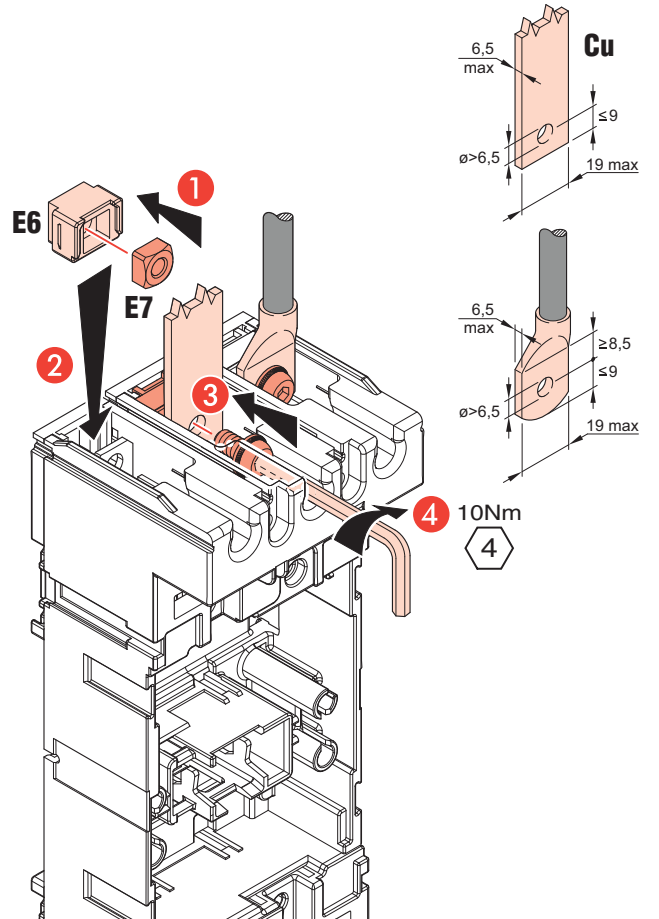

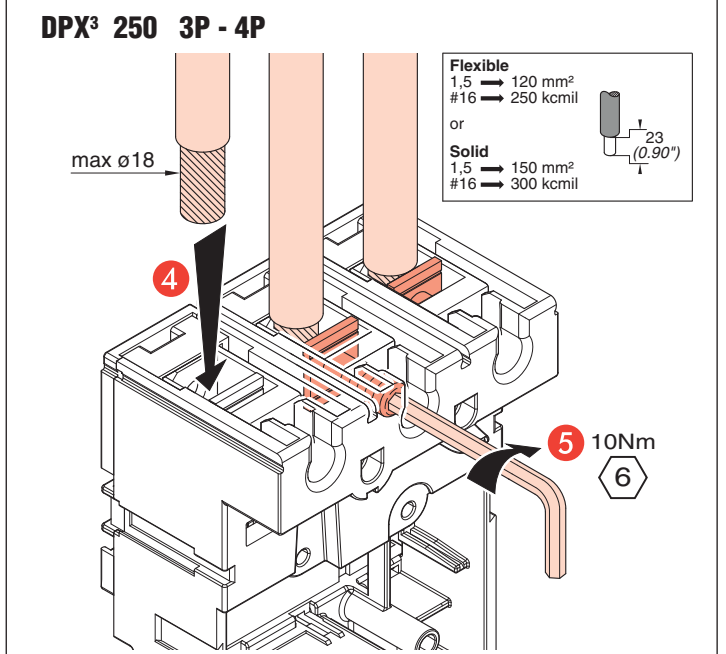
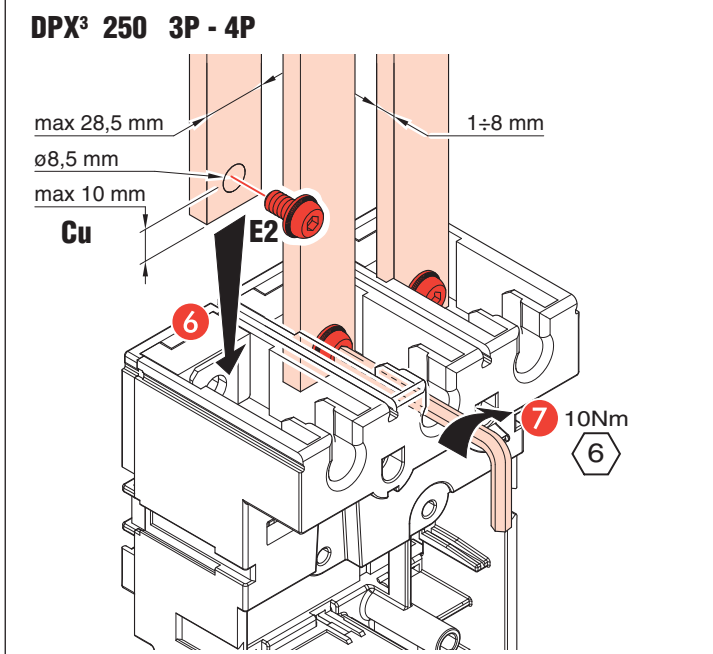
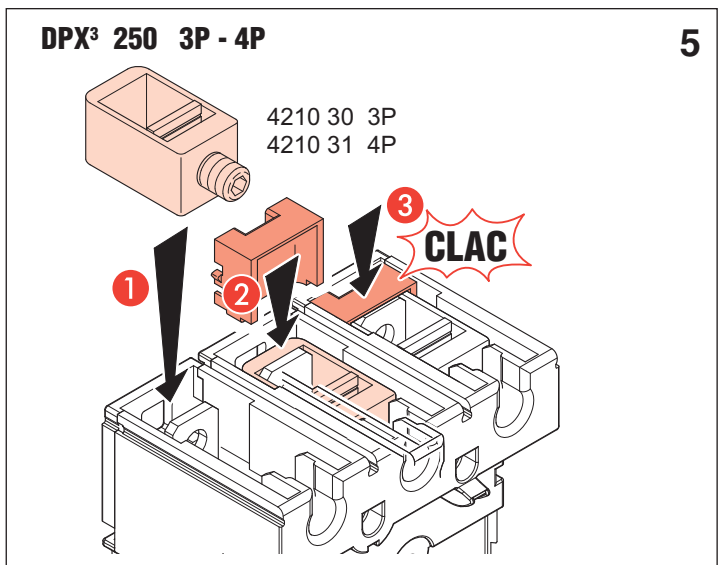
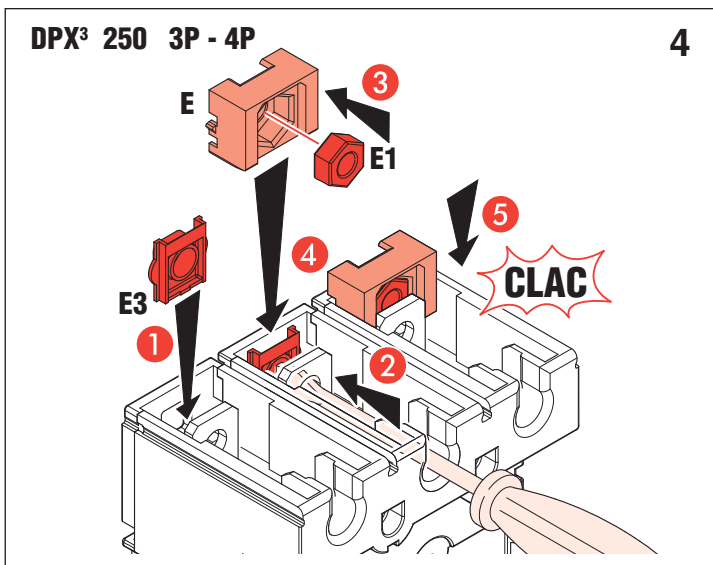
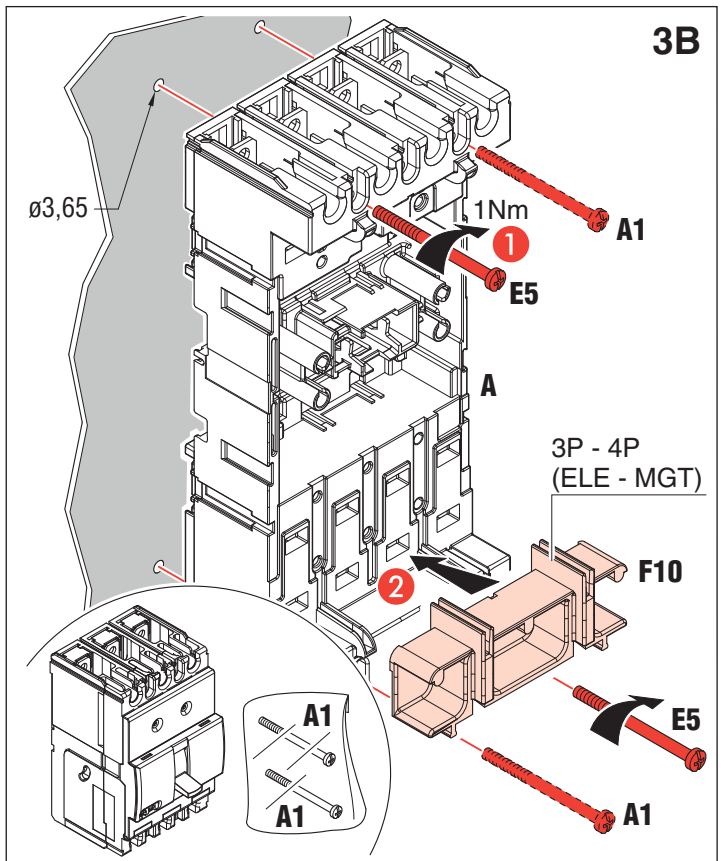
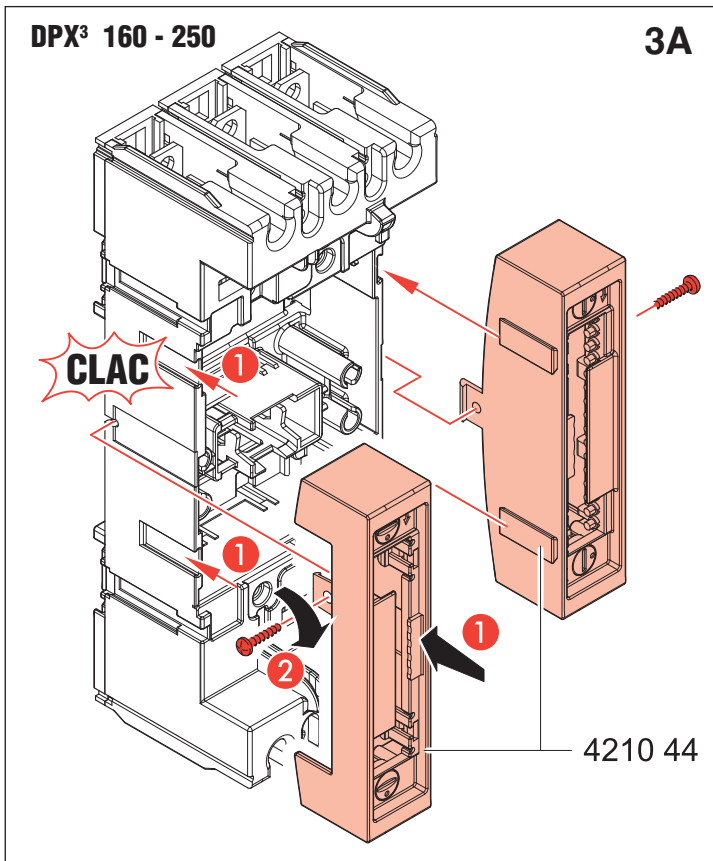

Flexible	1,5 → 120 mm ²	
	#16 → 250 kcmil	
or		
Solid	1,5 → 150 mm ²	
	#16 → 300 kcmil	

DPX³ 160 3P - 4P

6

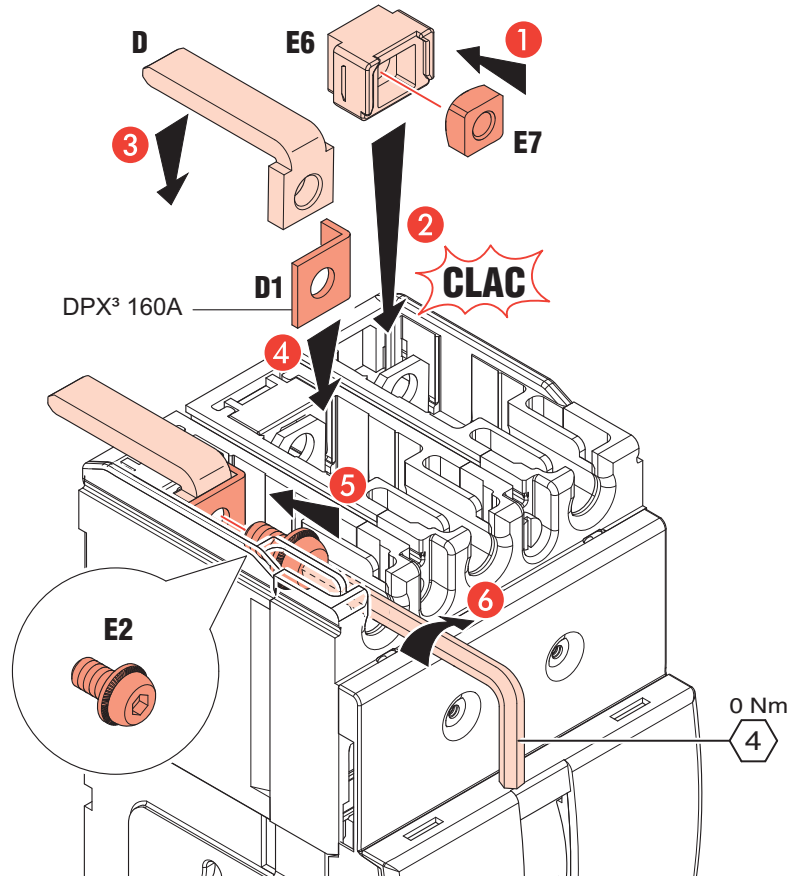

DPX³ 250 3P - 4P

7

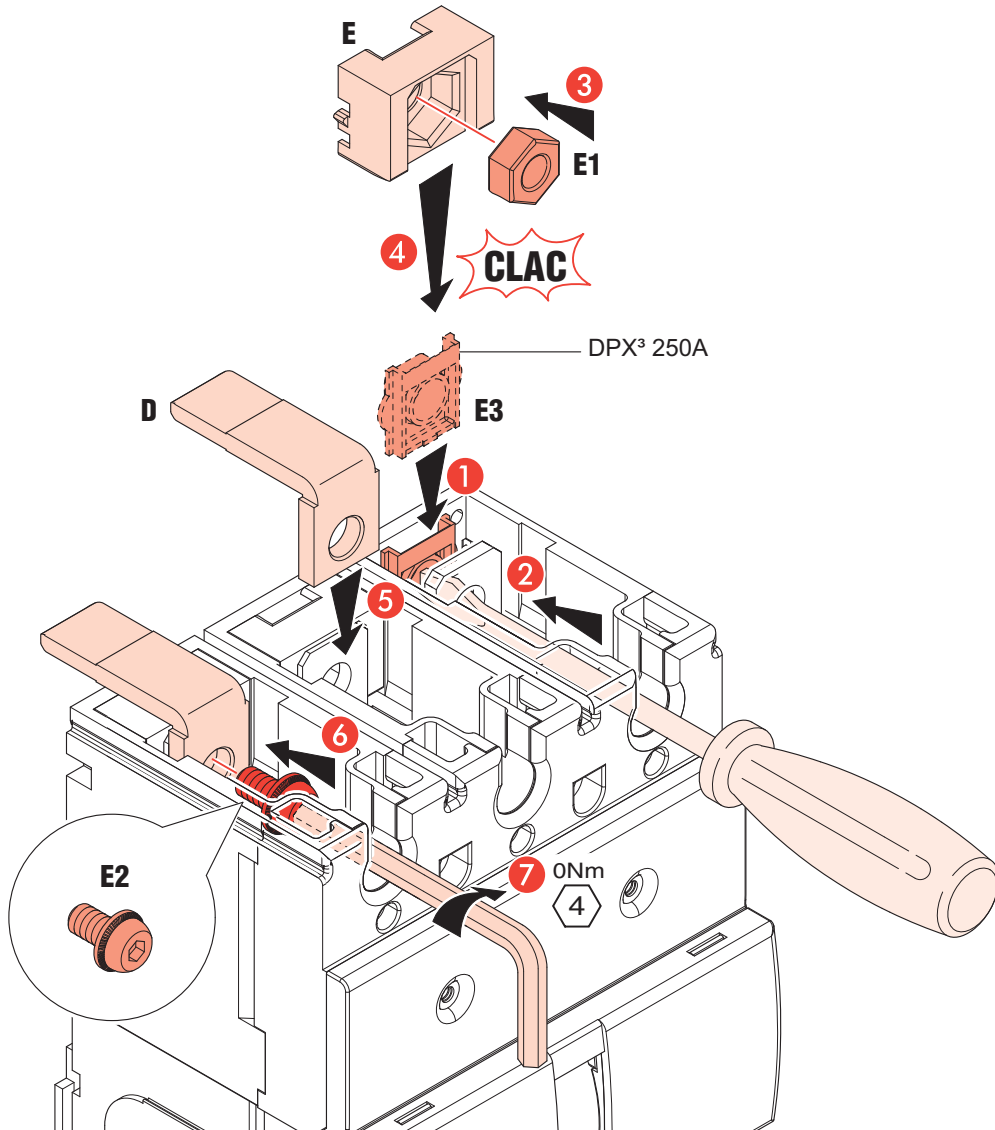

DPX³ 160 - 250 3P

8A

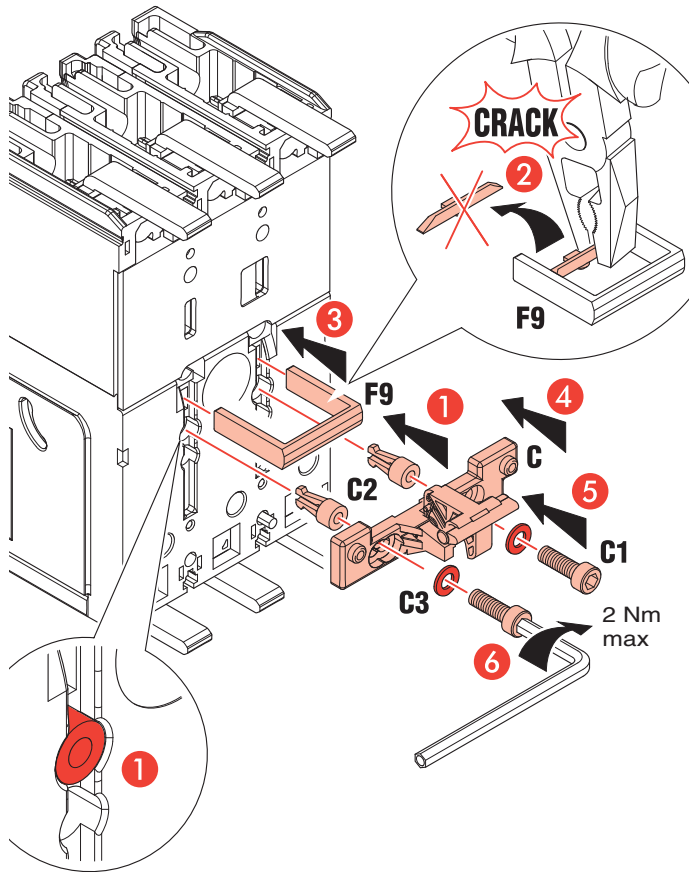

DPX³ 160 - 250 4P

8B

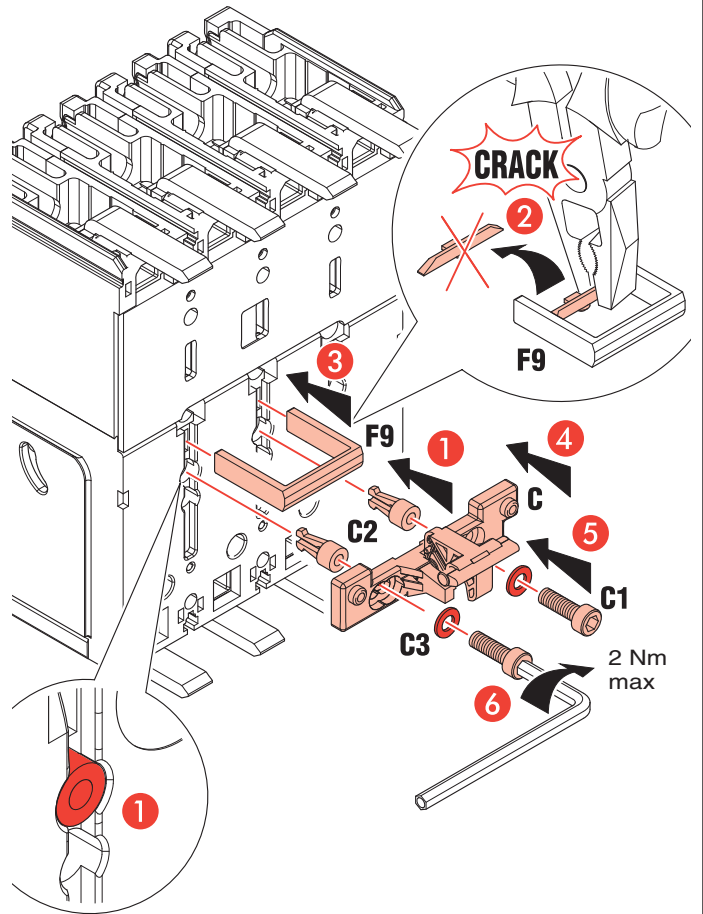

DPX³ 160 - 250

9A

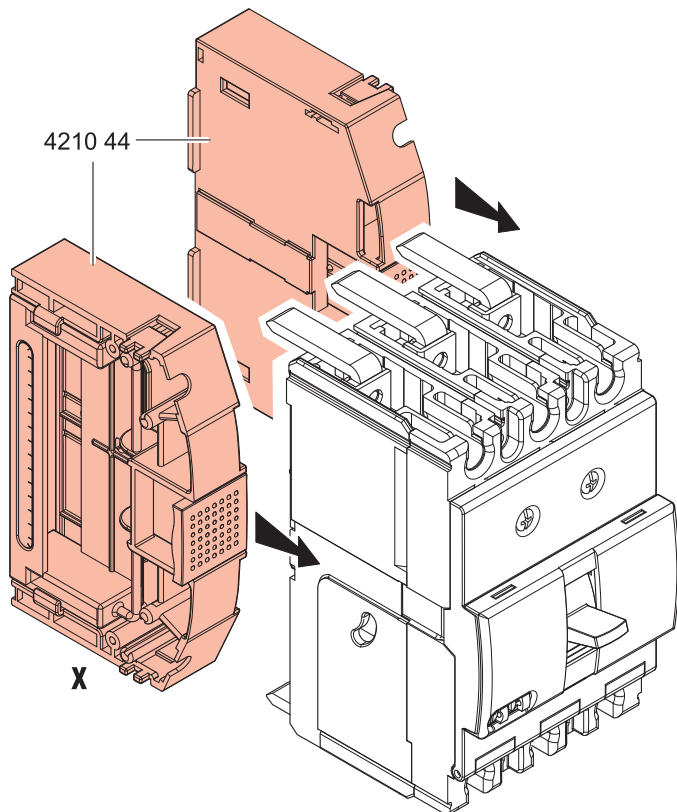

9B

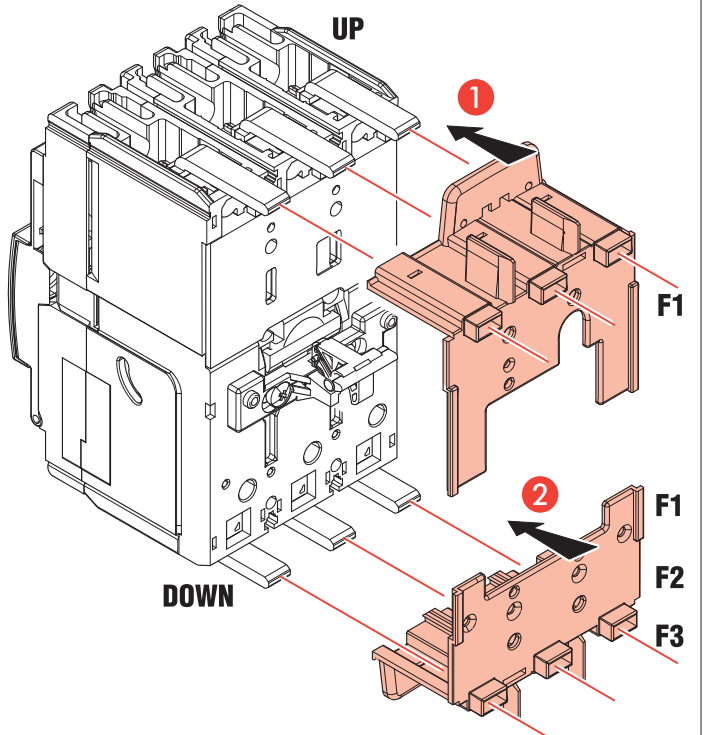

		UP	DOWN
DPX ³	160 3P	F1	F2
	160 4P / DIFF	F1	F1
DPX ³	250 3P / 4P	F1	F2
	250 DIFF	F1	F3

DPX³ 160 3P - 4P

10A

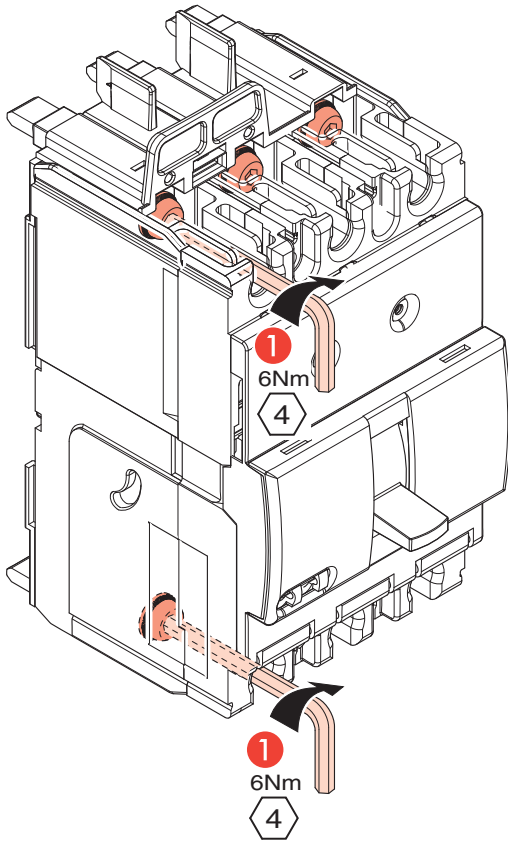

10B

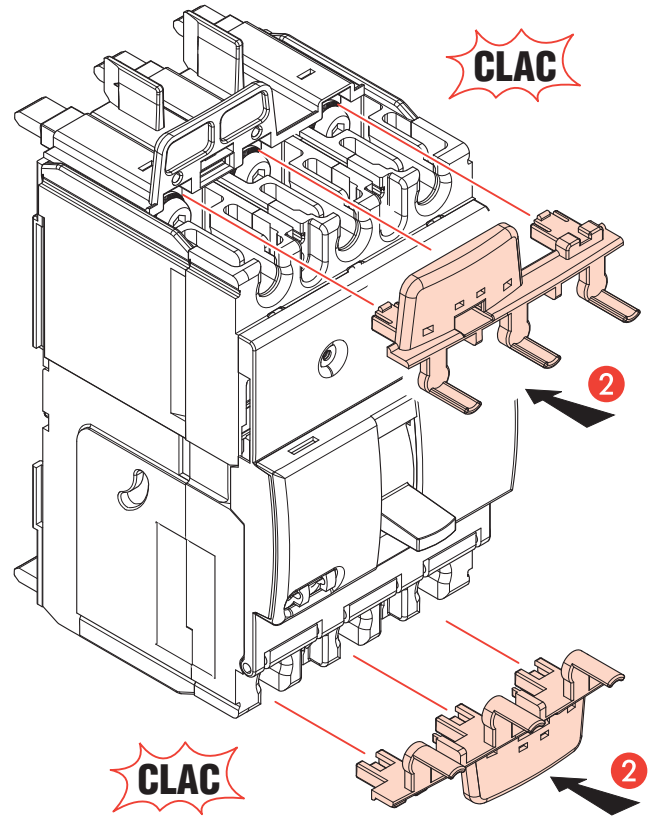

DPX³ 250 3P - 4P

11A

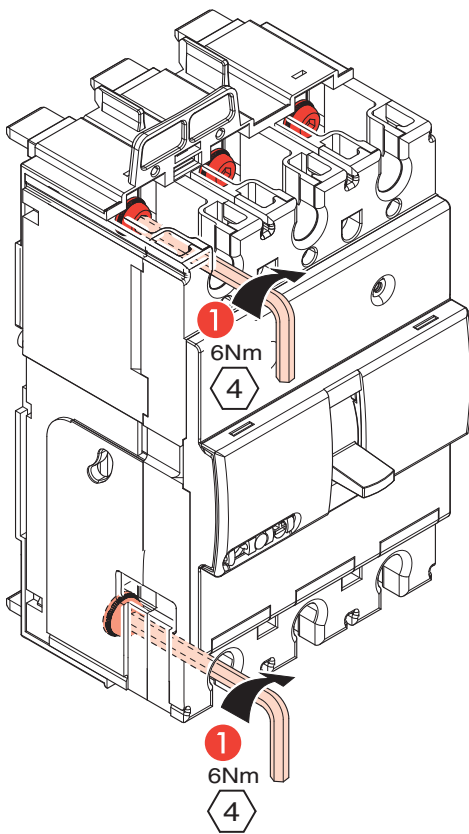

11B

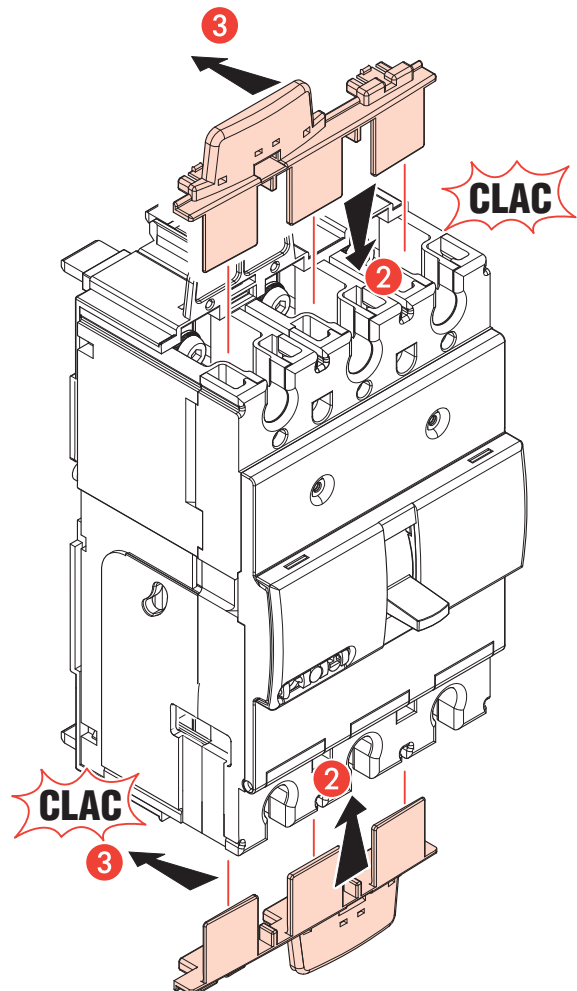

DPX³ 160 3P

12

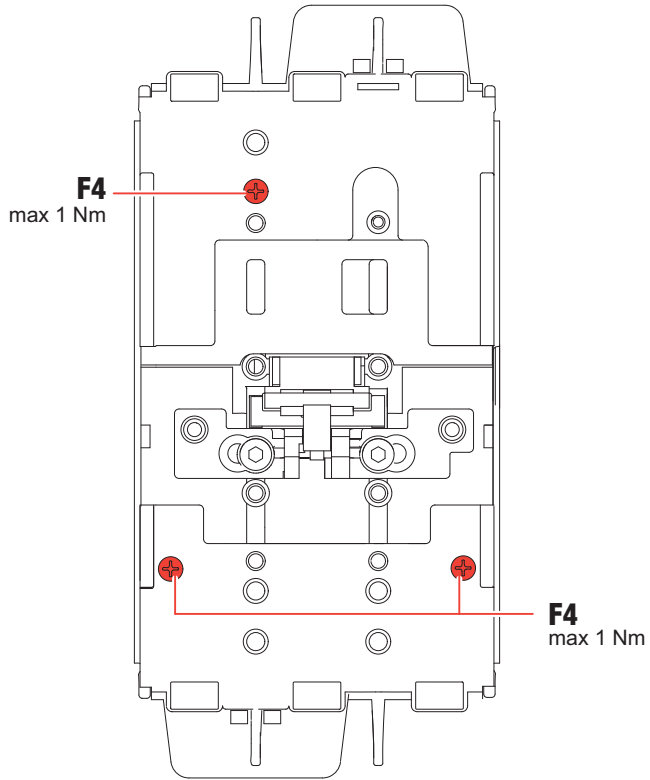

DPX³ 160 4P

13

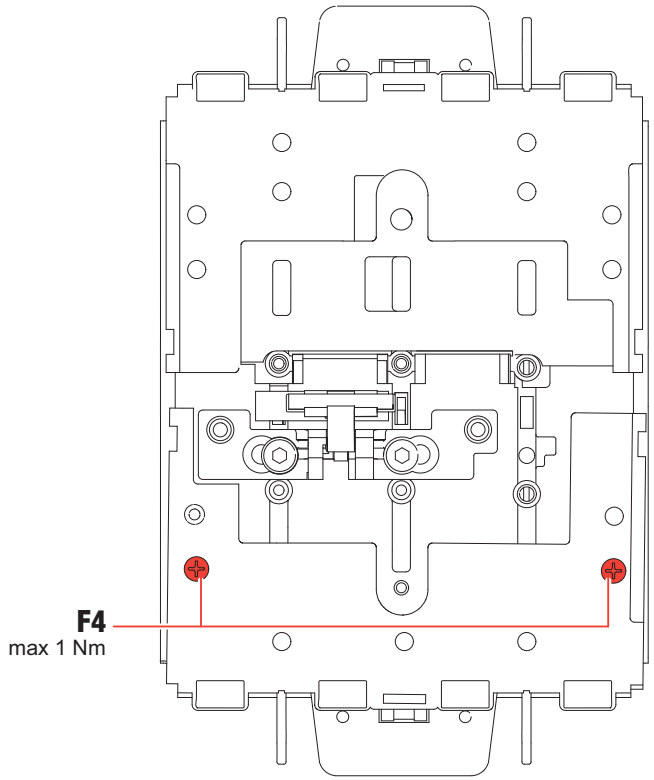

DPX³ 160 4P DIFF

14

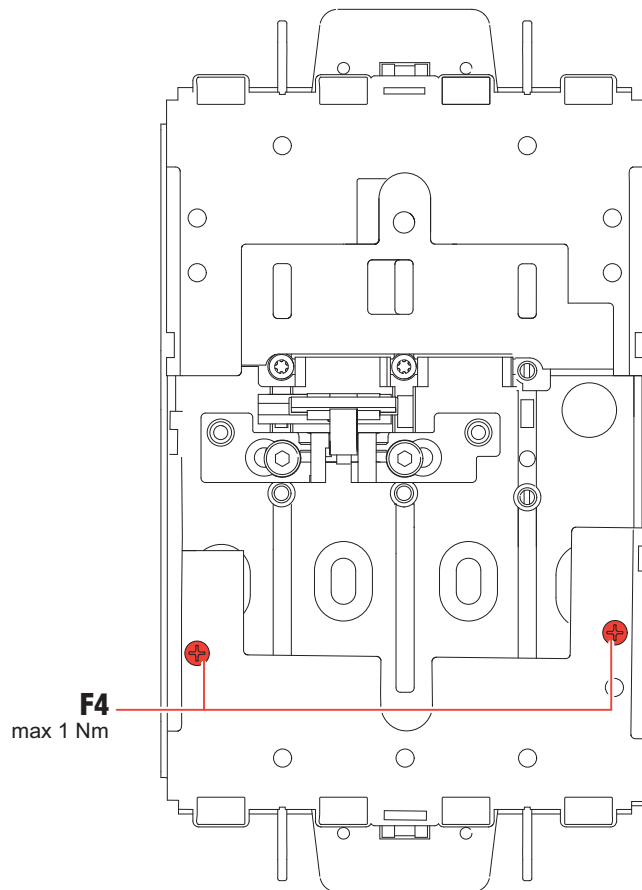

DPX³ 250 3P

15

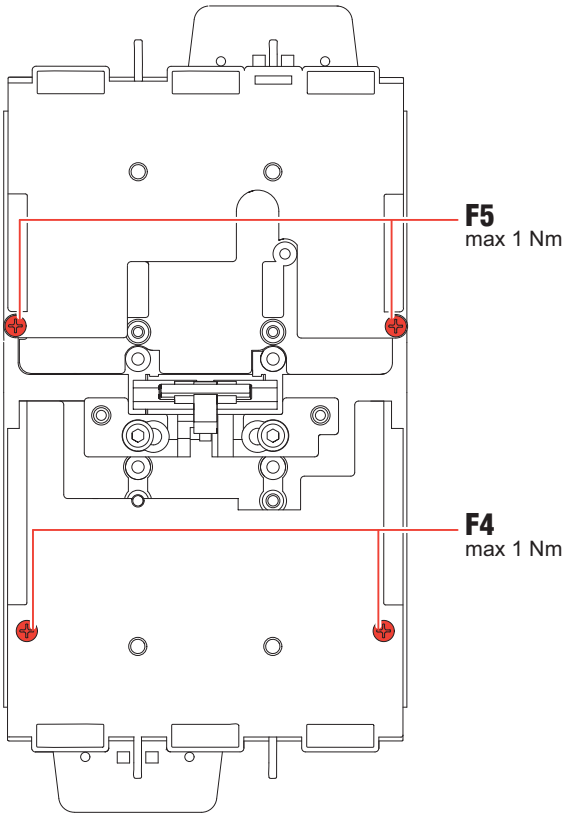

DPX³ 250 4P

16

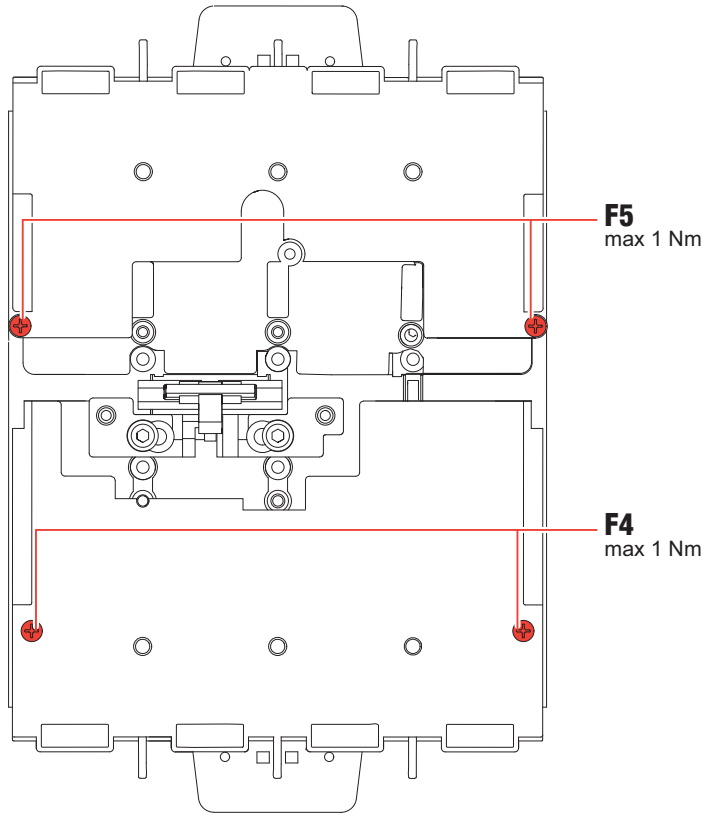

DPX³ 250 4P DIFF

17

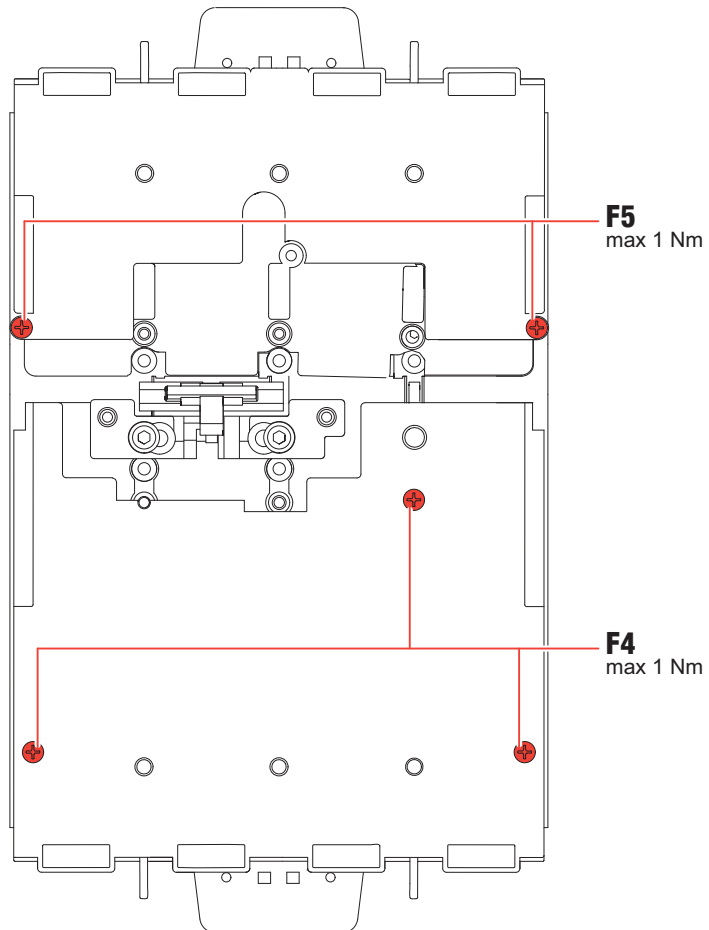

DPX³ 160 250 3P

18

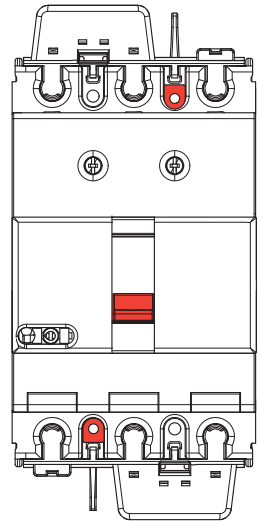
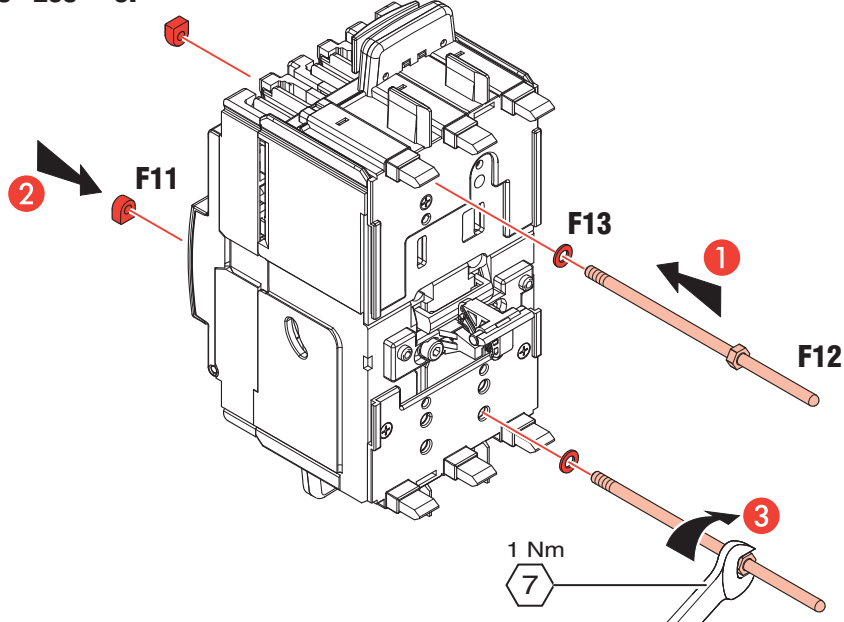

DPX³ 160 4P - 250 4P/DIFF

19A

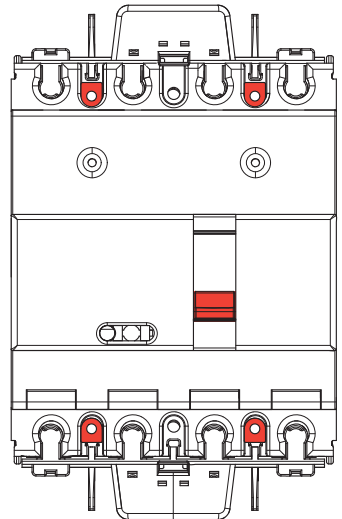
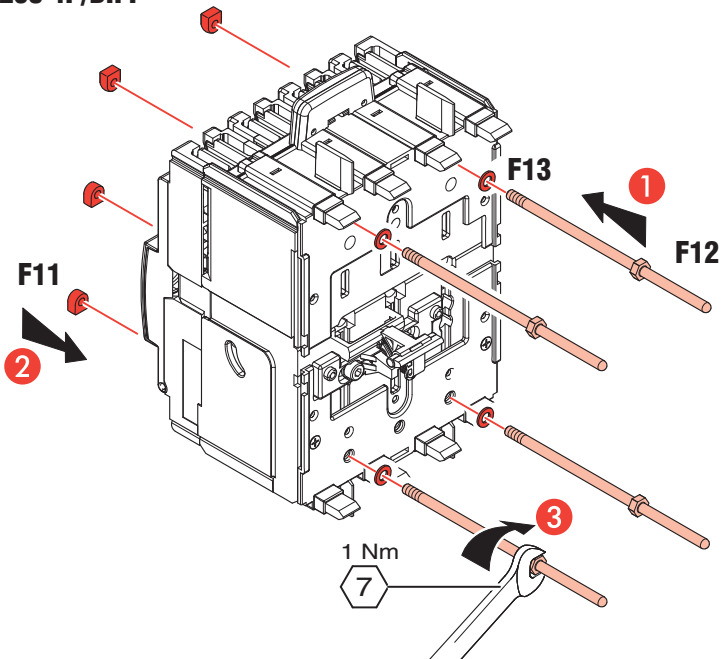

DPX³ 160 DIFF

19B

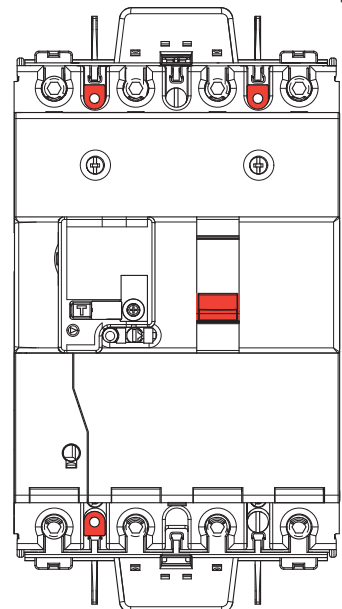
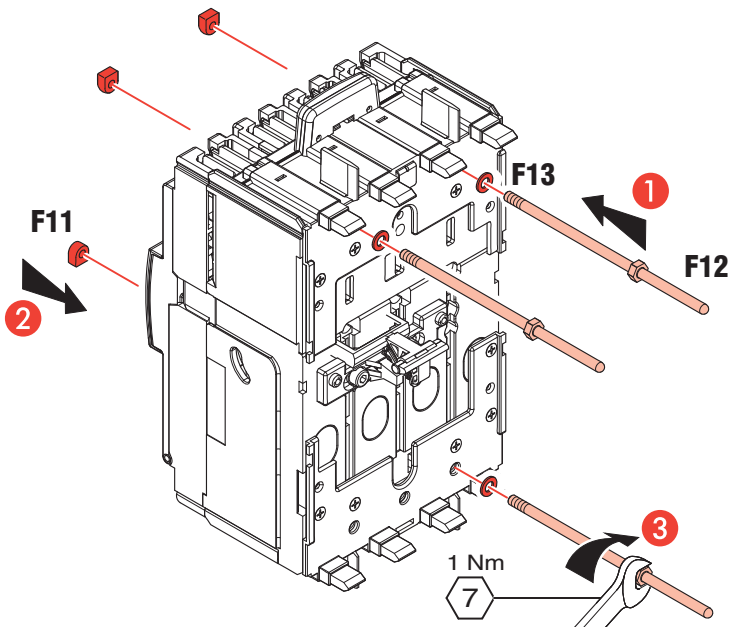

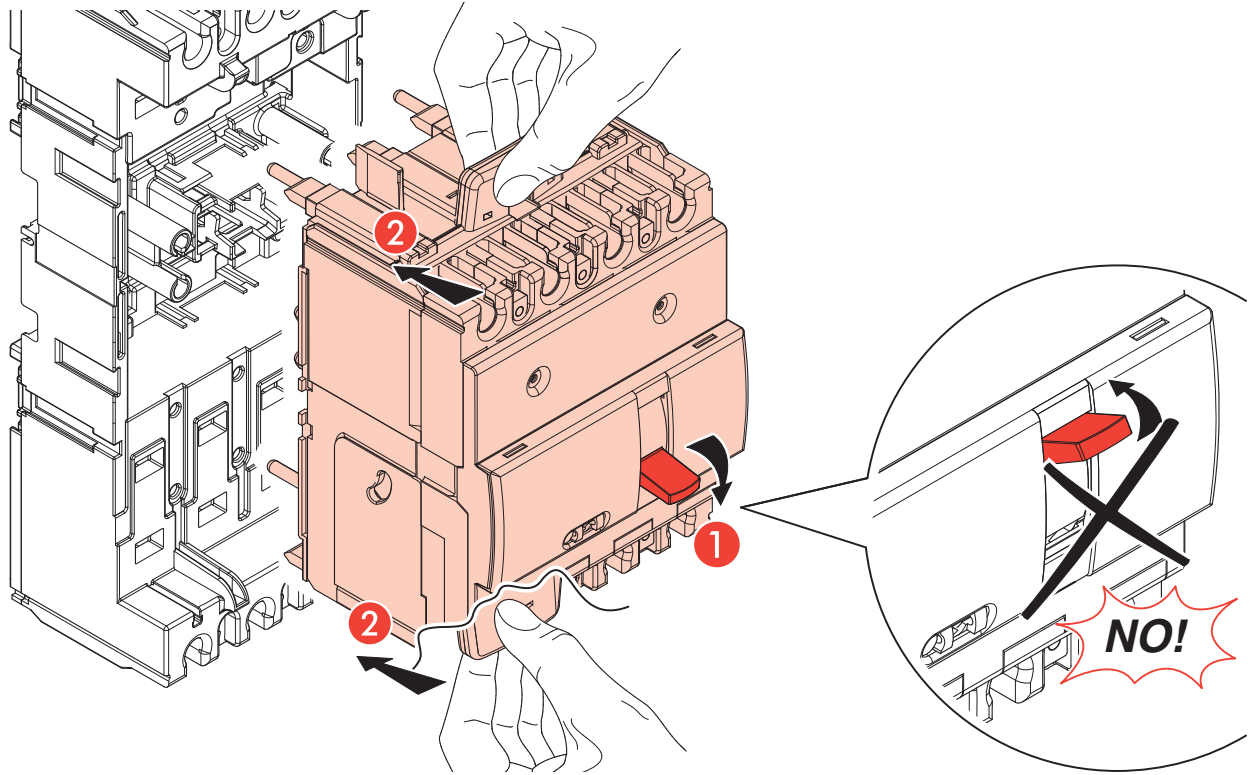

DPX³ 3P

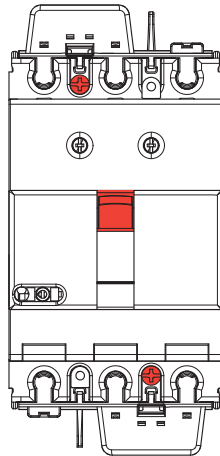

DPX³ 160 DIFF

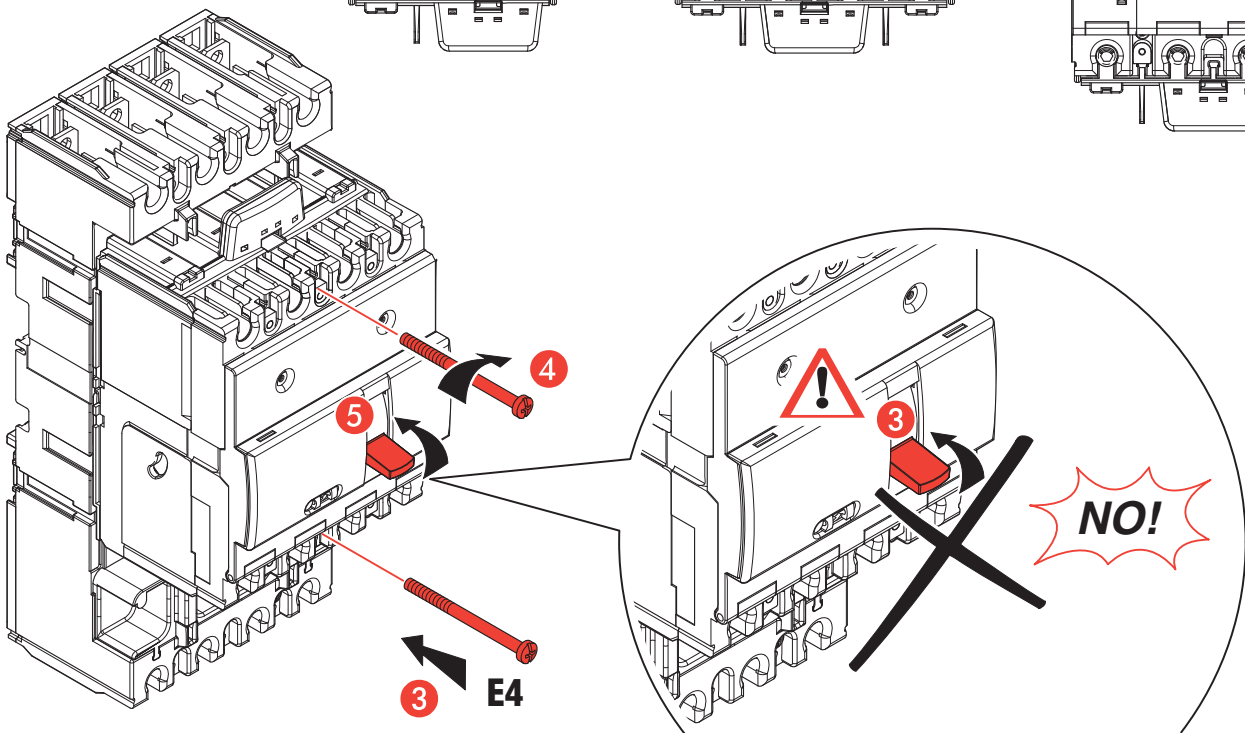
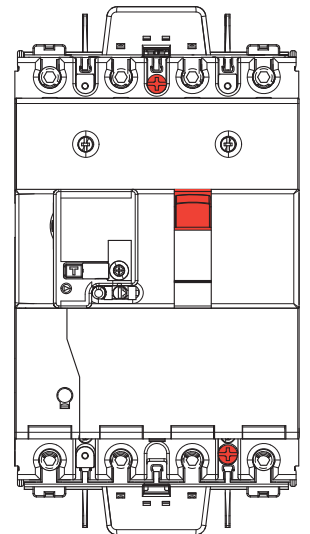
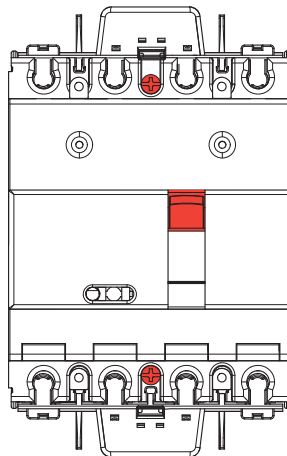

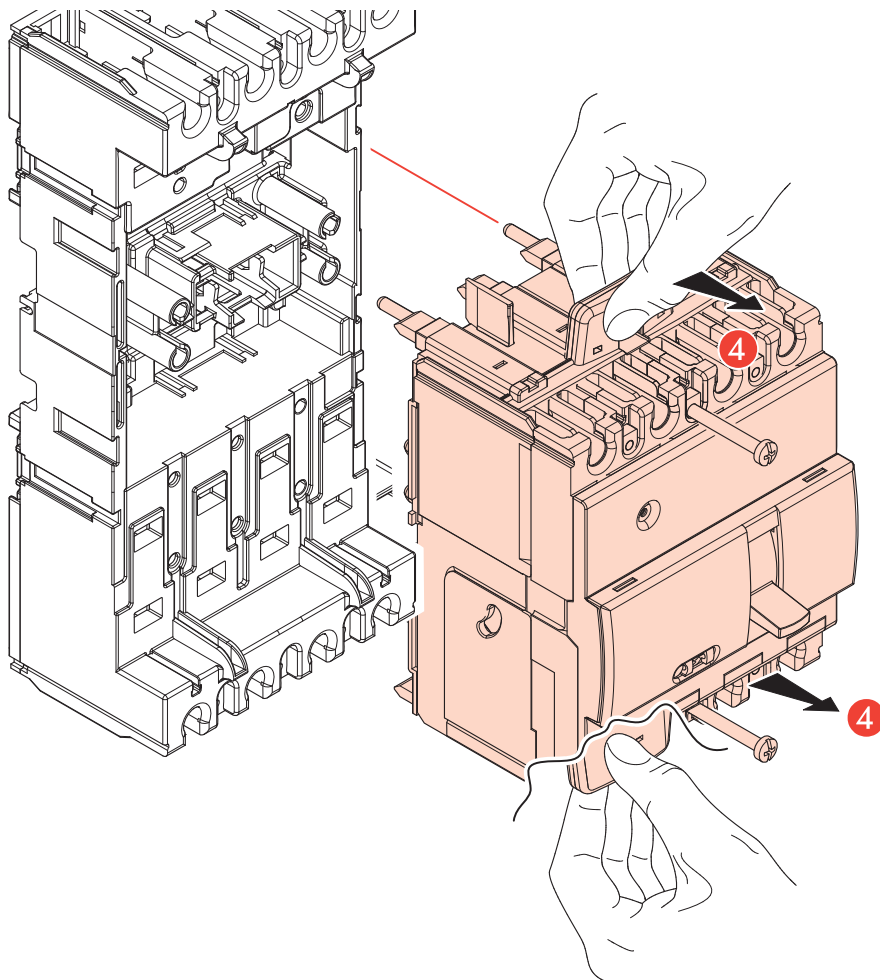
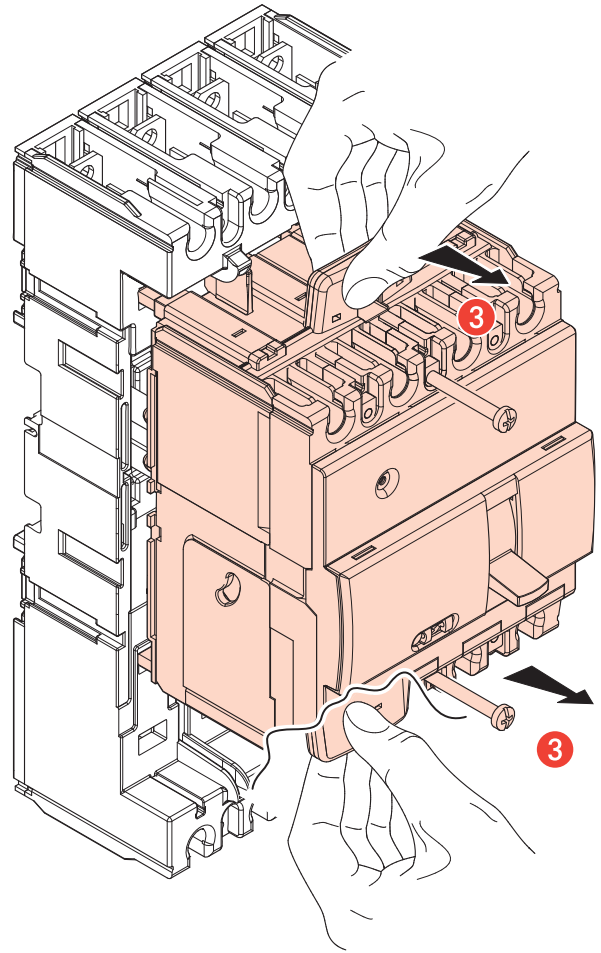
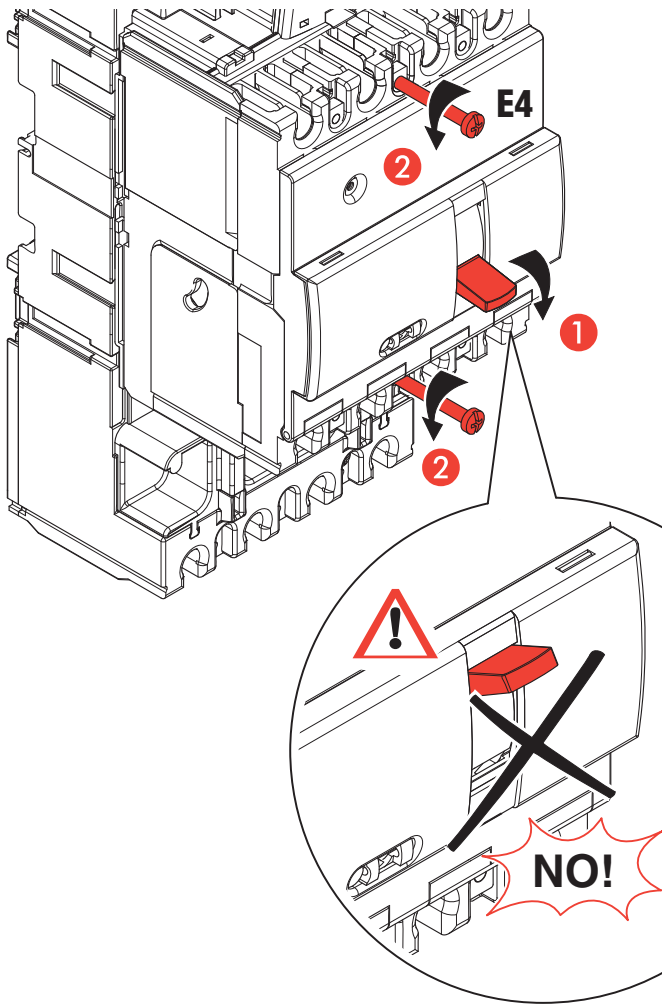

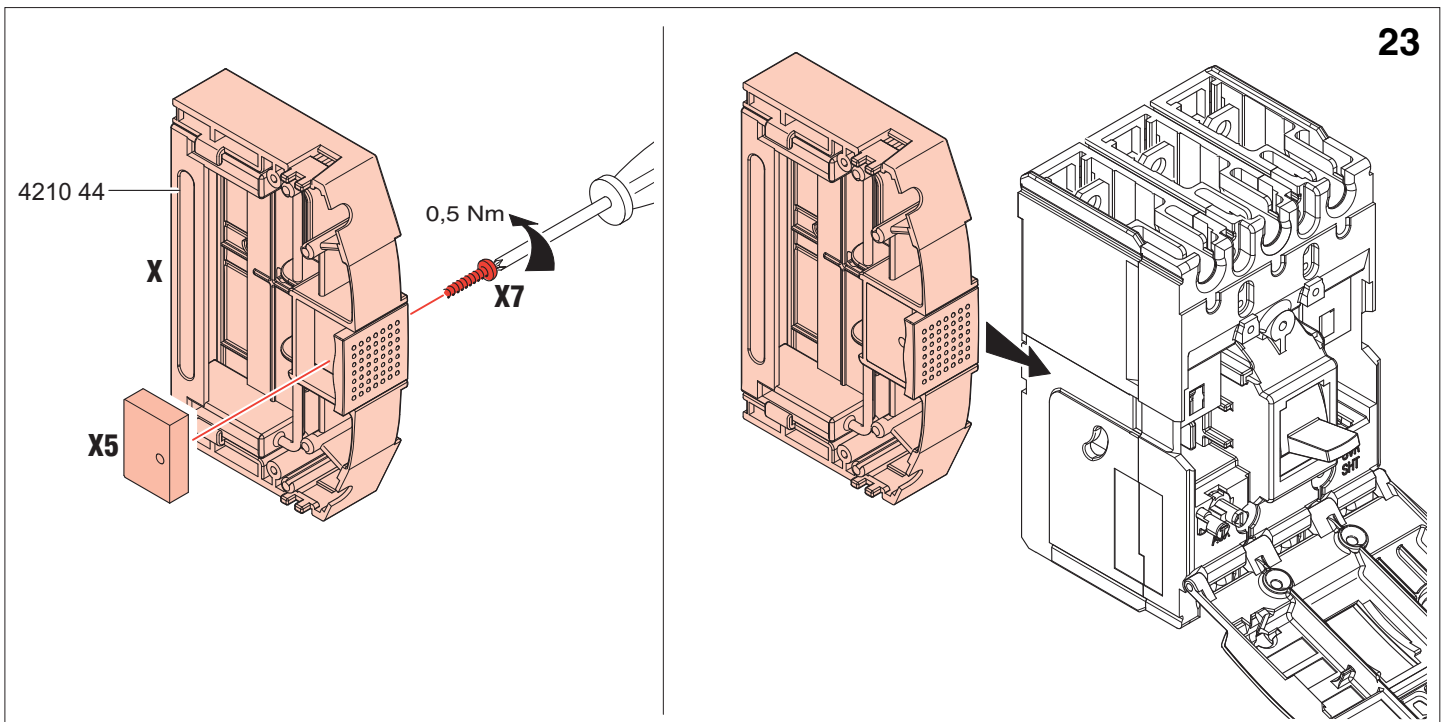
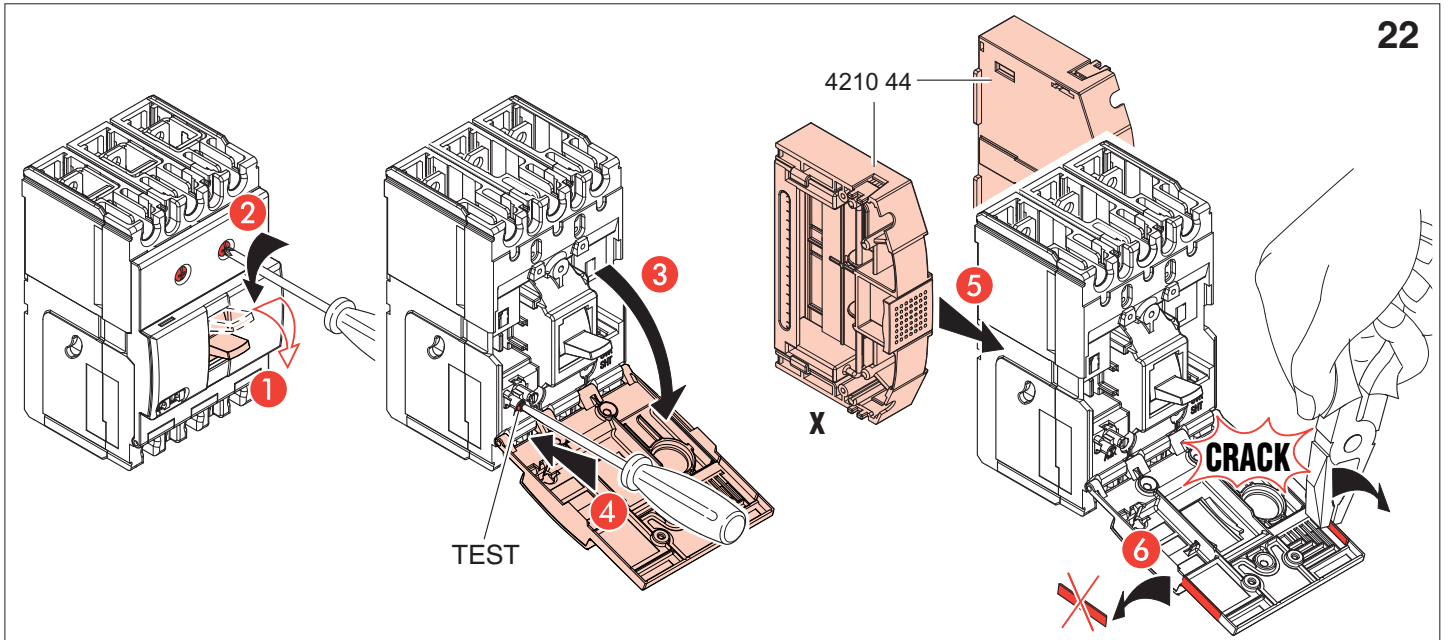
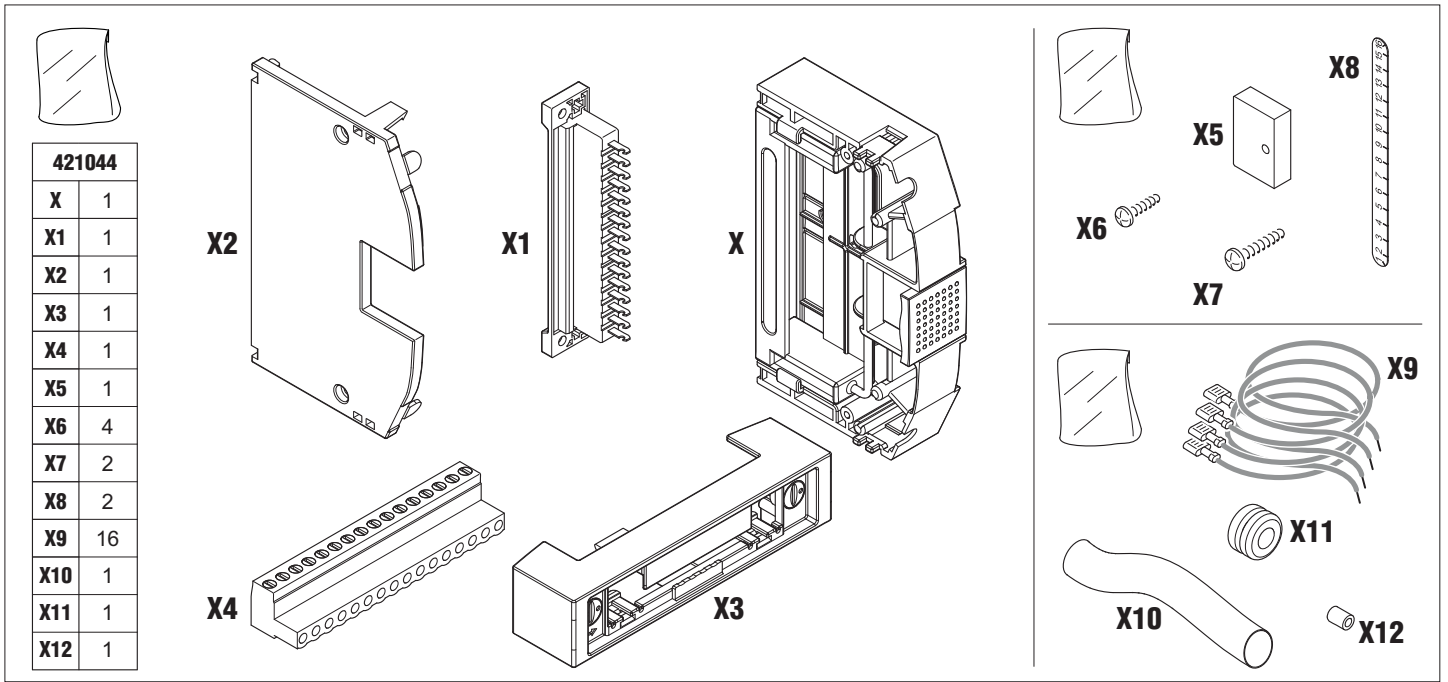

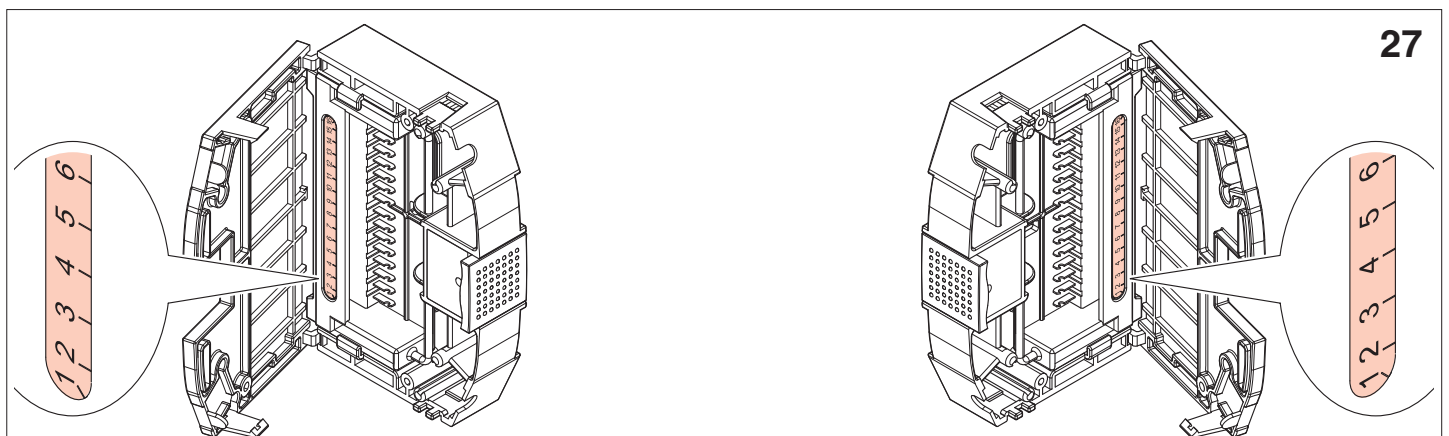
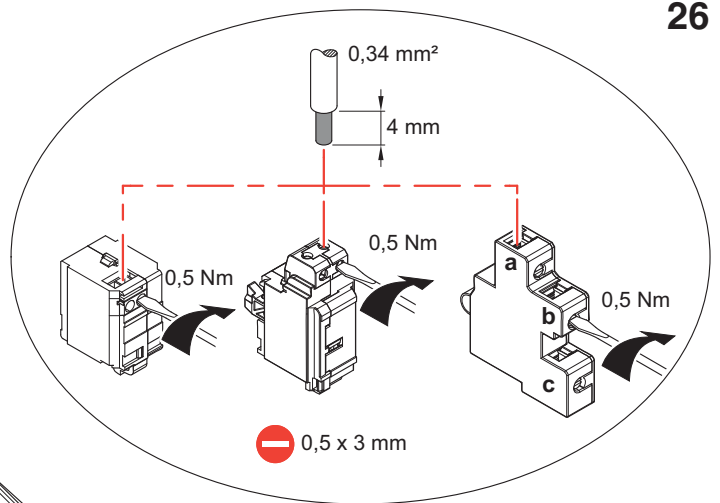
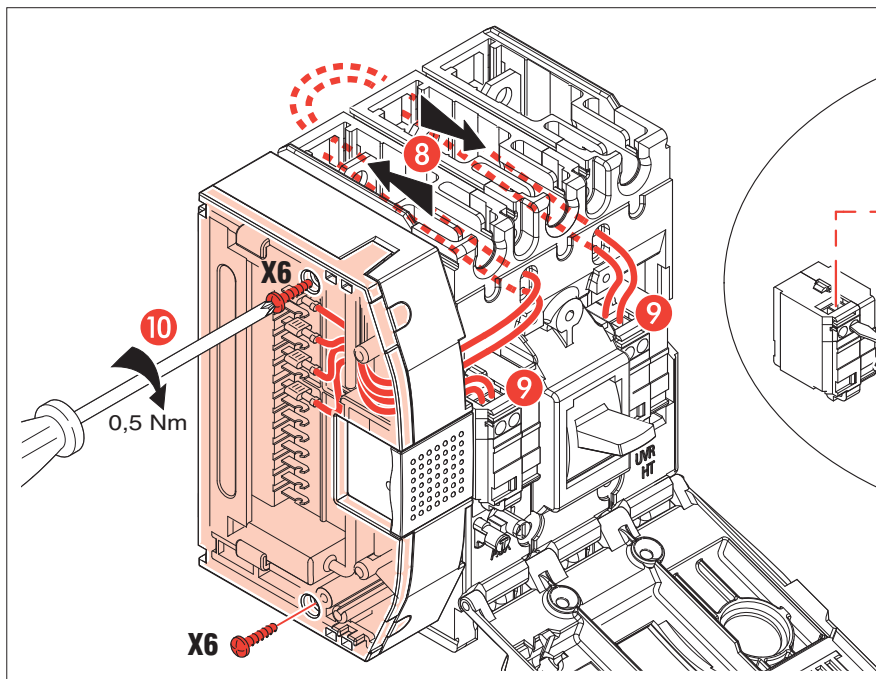
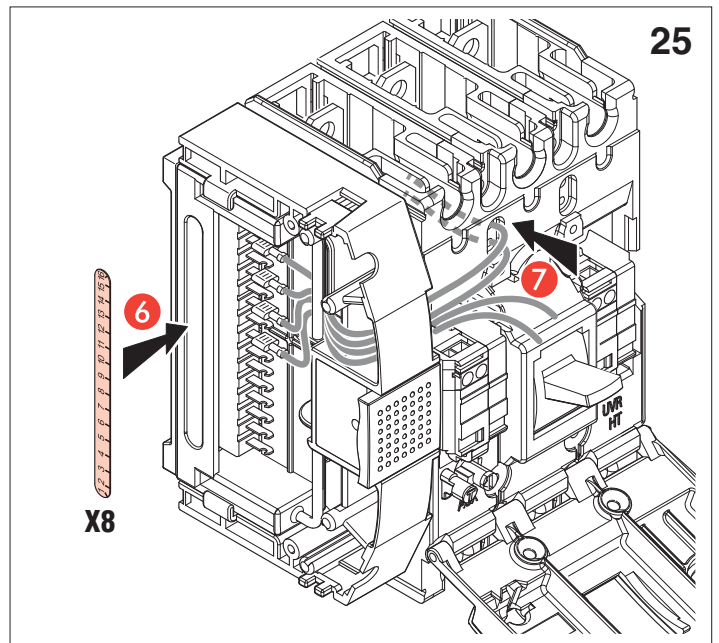
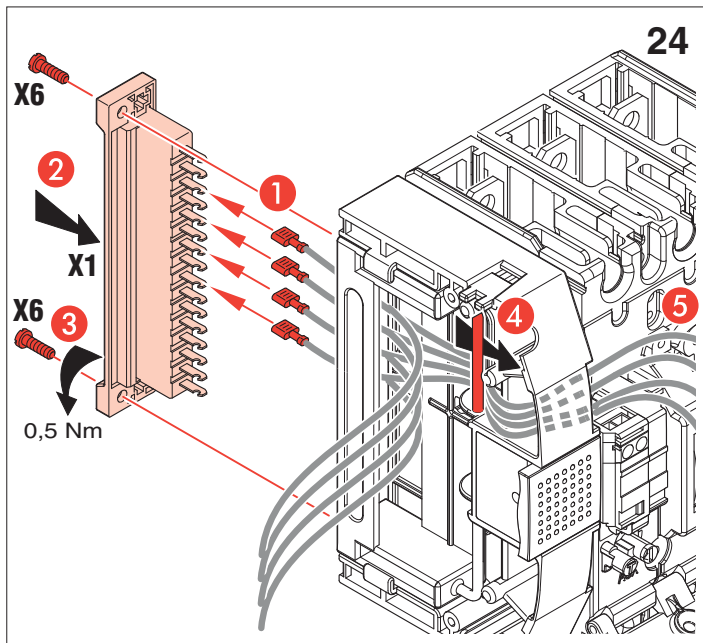

	1	2	3	4	5	6	7	8	9	10	11	12	13	14	15	16
DPX3	presence	presence				C2 (21)	C2 (22)	C2 (24)	S1 (51)	S1 (52)	S1 (54)	C1 (11)	C1 (12)	C1 (14)	ST/UVR	ST/UVR
MOT	M1	M2	M3	M4	M5	M6			S1 (51)	S1 (52)	S1 (54)	C1 (11)	C1 (12)	C1 (14)	ST/UVR	ST/UVR
RH	RH11	RH12	RH14	RH21	RH22	RH24			S1 (51)	S1 (52)	S1 (54)	C1 (11)	C1 (12)	C1 (14)	ST/UVR	ST/UVR

MOT: Motore - Motor - Moteur

RH: Manovra rotante - Rotary handling - Commande rotatif

28A

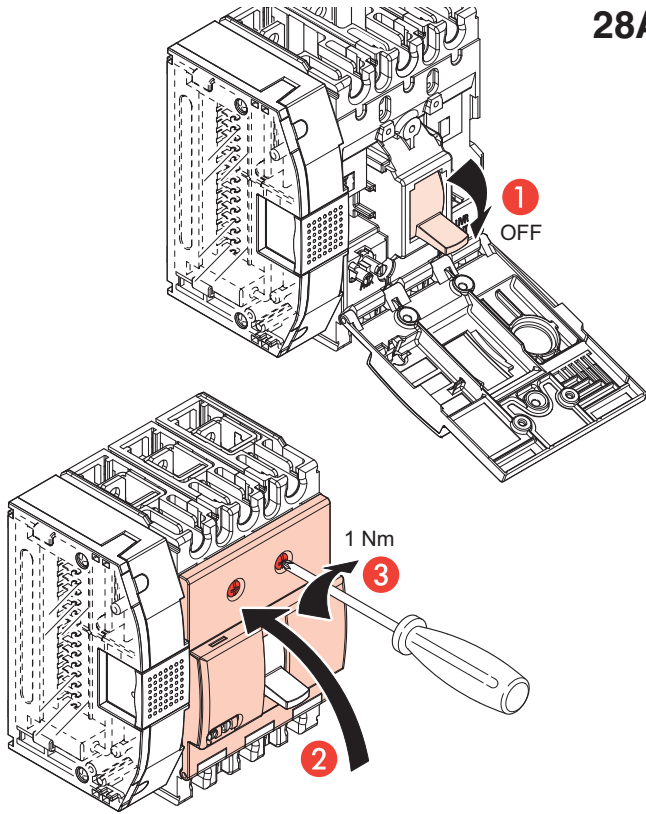

DPX³ 160 - 250

28B

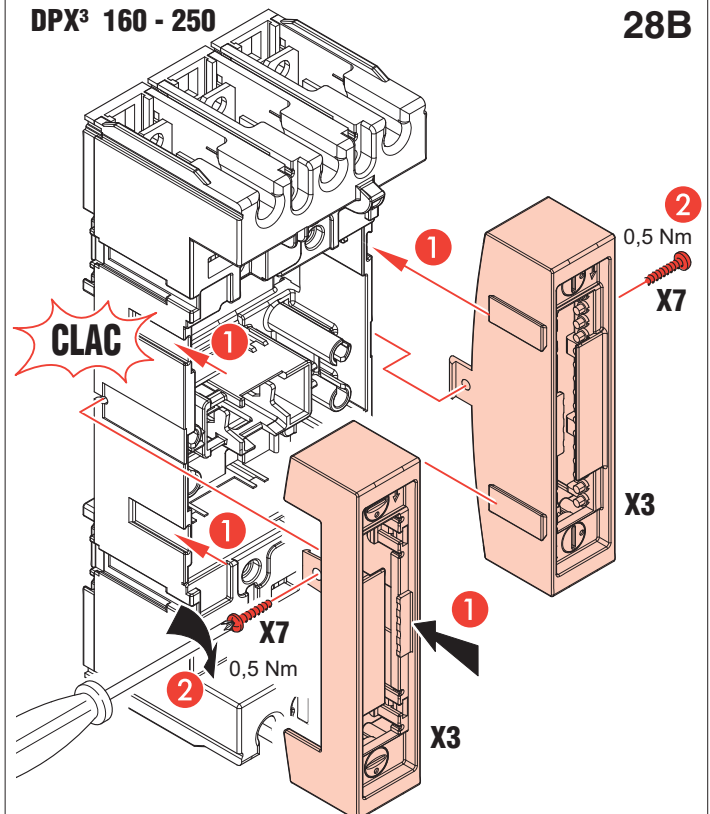

29

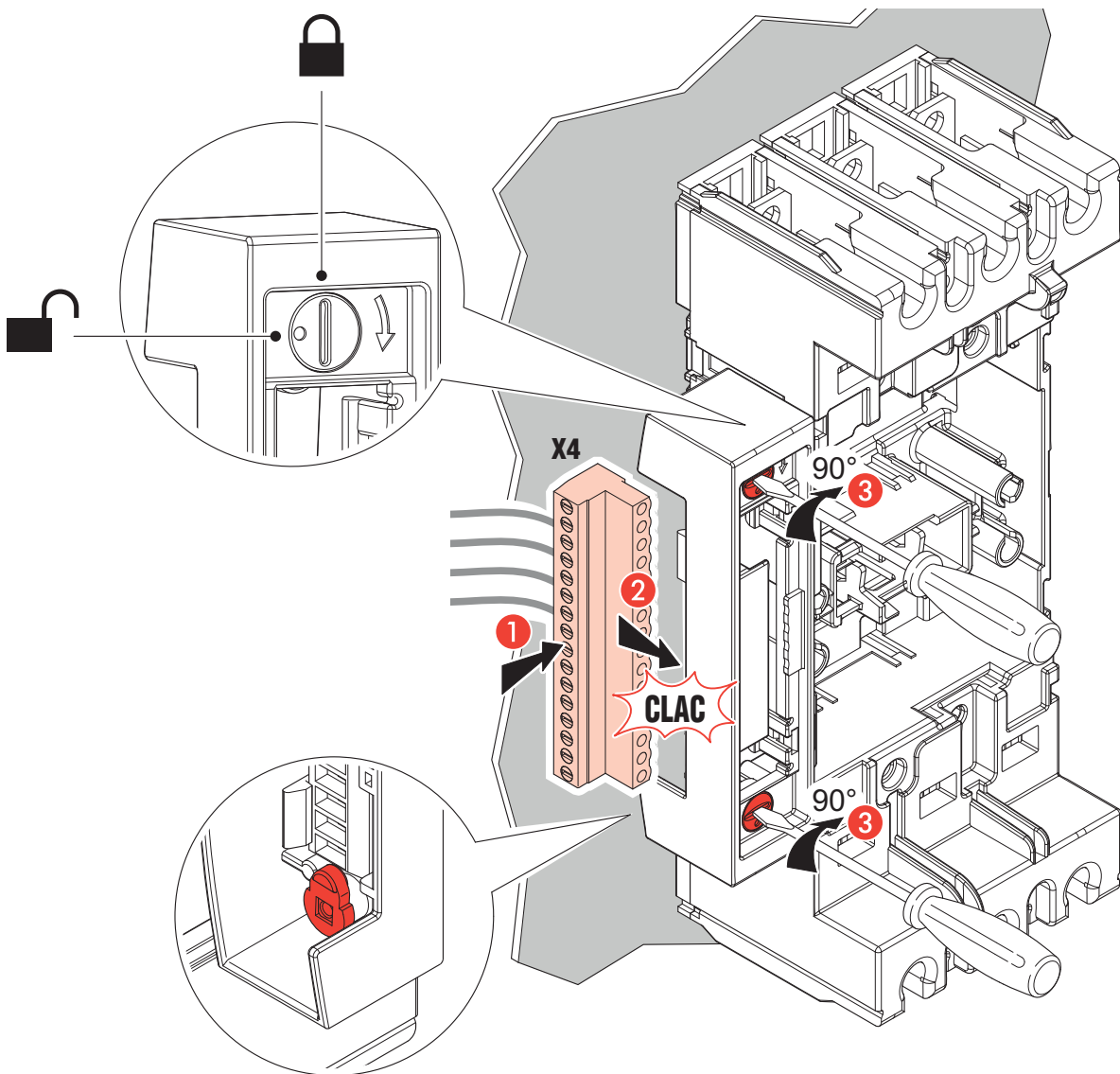

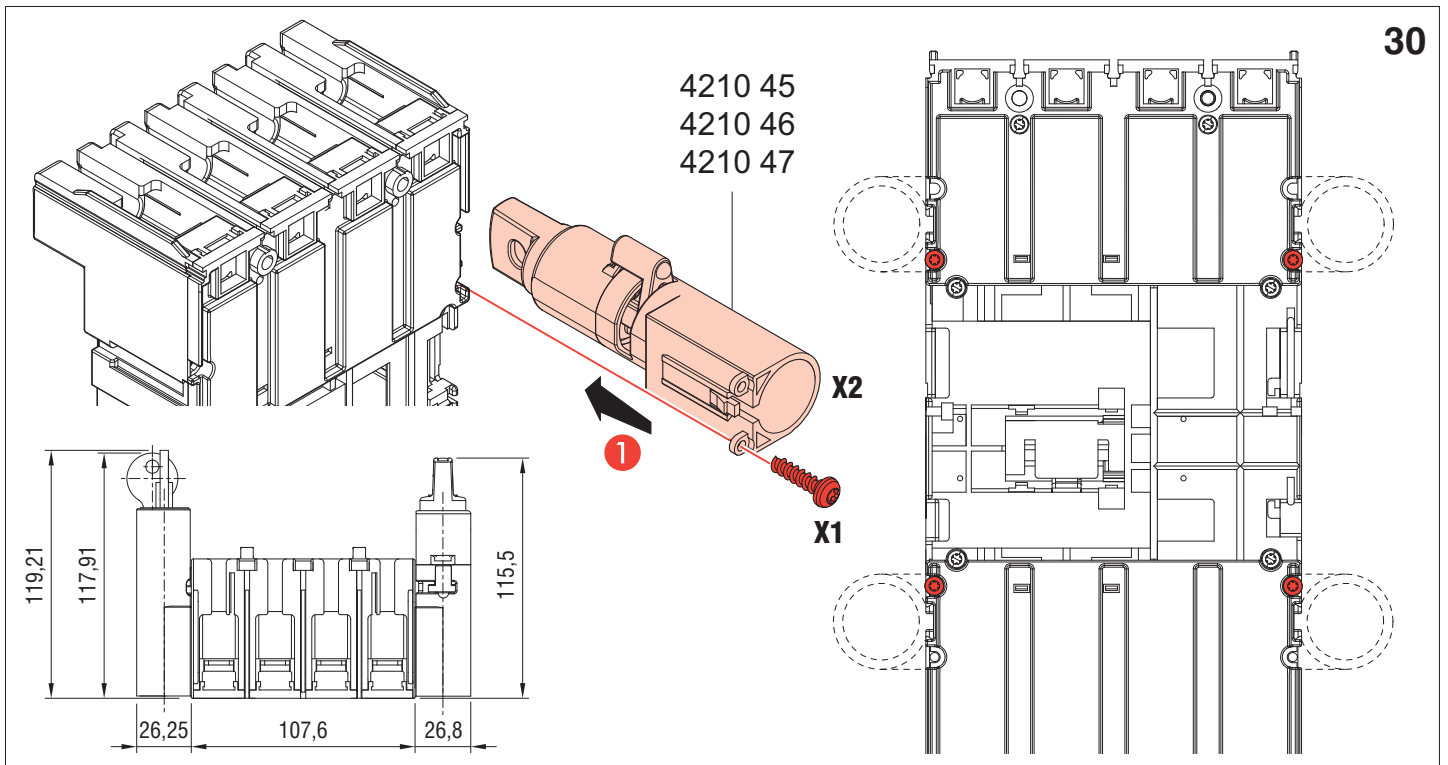
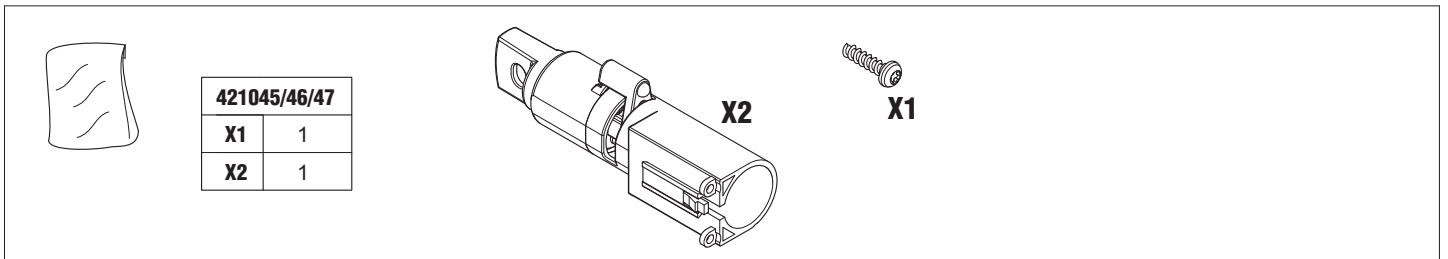

VERROUILLAGE LATÉRAL À CLÉ - LATERAL KEY LOCK OPTION - SLEUTELVERGREDELING LATERAAL 31
BLOQUEO CON LLAVE MODULO LATERAL - ACCESSORIABILITÀ BLOCCHI A CHIAVE CON MODULO LATERALE
ACESSORIZAÇÃO ENCRAVAMENTO POR CHAVE COM MÓDULO LATERAL - OPCJA BLOKADY KLUCZEM
MODUŁU BOCZNEGO - YANAL ANAHTARLI KILIT SEÇENEĞİ - ЗАМОК С БОКОВЫМ МОДУЛЕМ

DPX³ 160A

		1	2	3	4
L		NO	OK	NO	OK
R		OK	NO	OK	NO

DPX³ 250A

		1	2	3	4
L		NO	OK	OK	OK
R		OK	NO	OK	OK

**VERROUILLAGE À CLÉ POUR INVERSEUR DE SOURCE - KEY LOCK FOR INTERLOK OPTION -
 INTERLOK SLEUTELVERGRENDING - BLOQUEO CON LLAVE PARA INTERBLOQUEO -
 ACCESSORIABILITÀ BLOCCHI A CHIAVE CON INTERBLOCCO - ACESSORIZAÇÃO ENCRAVAMENTO POR
 CHAVE COM ENCRAVAMENTO - OPCJA BLOKOWANIA KLUCZEM DO BLOKADY POMIĘDZY APARATAMI
 INTERLOK MEKANIZMASI İÇİN ANAHTARLI KILIT - БЛОКИРАТОР ДЛЯ ВЗАИМОБЛОКИРОВКИ**

32

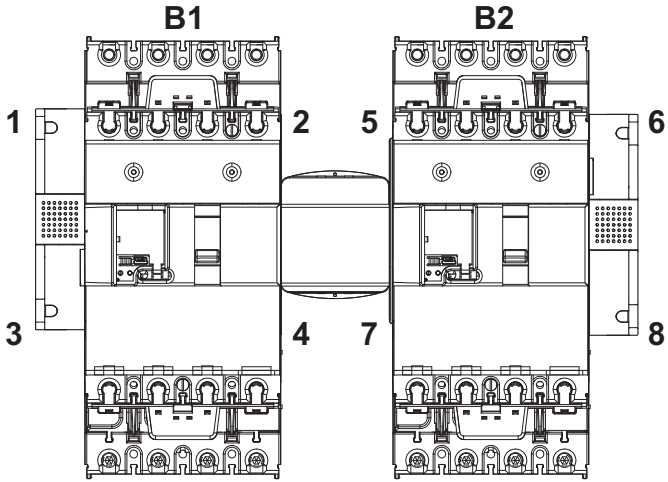

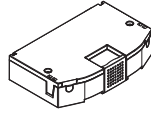
									
B1	B2	1	2	3	4	5	6	7	8
160 3P-4P/DIFF	160 3P-4P/DIFF	NO	NO	NO	OK	NO	NO	OK	NO
	250 3P-4P/DIFF	NO	NO	NO	OK	OK	NO	OK	OK
250 3P-4P/DIFF	160 3P-4P/DIFF	NO	OK	OK	OK	NO	NO	OK	NO
	250 3P-4P/DIFF	NO	OK	OK	OK	OK	NO	OK	OK

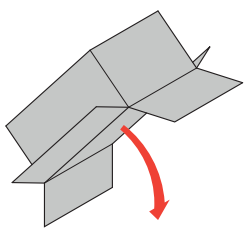

A

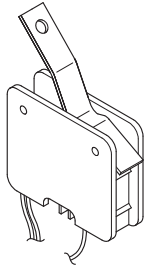

	4210 48
A	1

3A / 250V

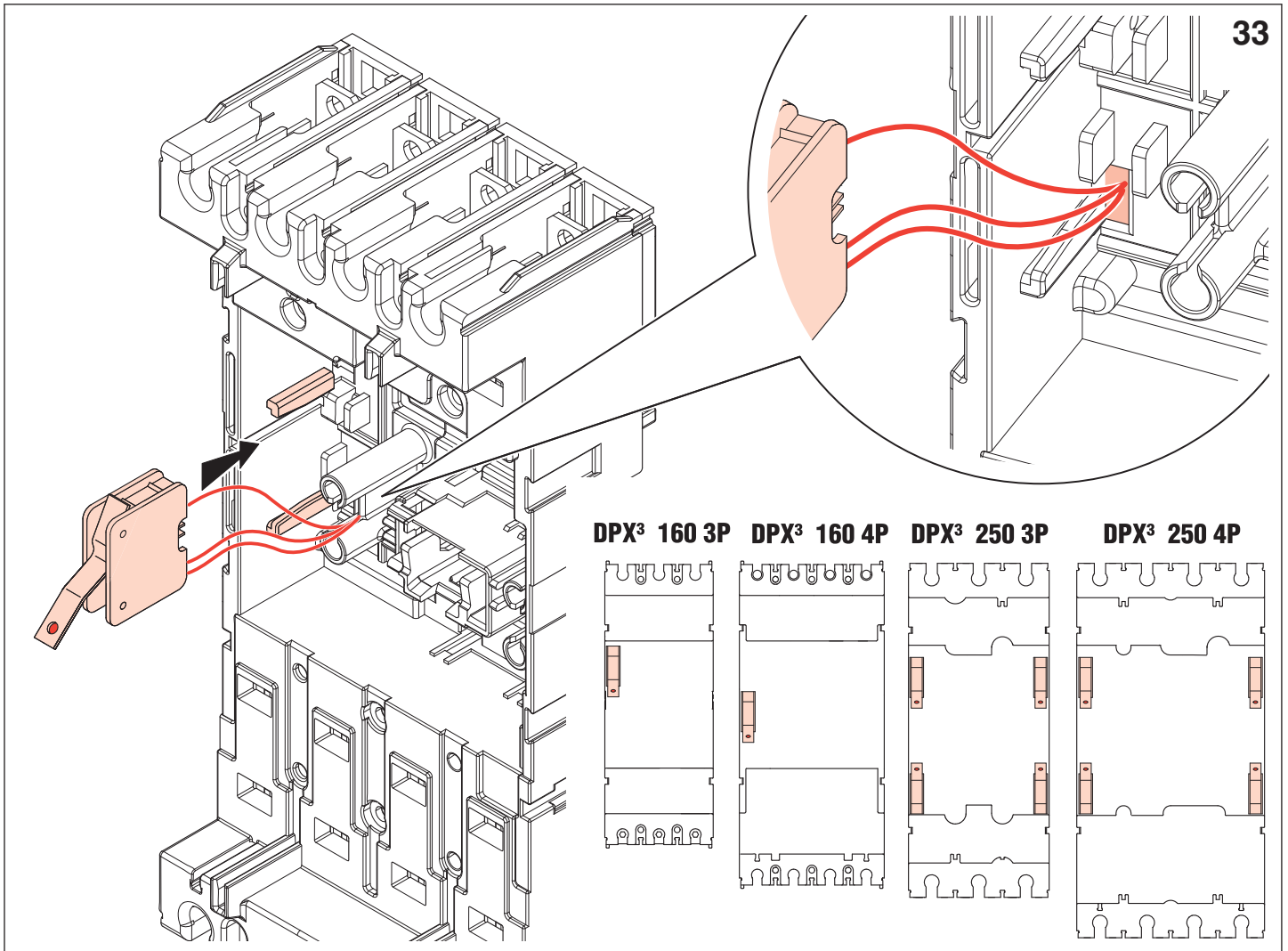
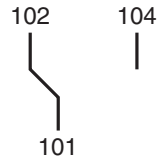

33